



# CASE STUDY

CALL US AT 1-800-209-5137  
[WWW.FLOWCARESOLUTIONS.COM](http://WWW.FLOWCARESOLUTIONS.COM)

## SITUATION

After Design Development, this new 25 bed hospital in the Midwest began the arduous process of vetting multiple vendors to outfit the hospital with necessary storage and equipment to support their critical spaces. The main goal of the organization was to design first and foremost around the patient and second, to optimize the flow of materials from dock-to-patient care and beyond.

## IS THERE A MULTI-SERVICE PROVIDER?

### FLOWCARE SOLUTIONS GROUP ANSWERS THE CALL

The system's project team and architect were introduced to FlowCARE Solutions Group through a recommendation from another entity that spoke highly of their comprehensive capabilities and attention to detail. After the initial discovery meetings, FSG worked with each of the departmental user groups to establish their current-state and to determine the optimal material storage solutions for their day-to-day process.

Simultaneously, FlowCARE's EDAC team & Equipment planners conducted a detailed analysis of each department's specific equipment needs and grouped them into existing vs. new solutions. Together, FSG's MEP and Design-Assist team collaborated with the hospital's supply-chain and project construction team to create a storage road map that included: allocated space relative to existing, Lineal Storage feet, expected growth, new technologies, and relationship to point-of-care.



# COMPREHENSIVE PLANNING

Effective storage solution planning and MEP requires a thorough understanding of the project team's long term objectives. FlowCARE Solutions Group brings over 50 years of combined experience in doing just that - and by empowering our consultants, you will not only free-up precious time for other project tasks, but your supply chain will improve drastically, resulting in higher patient scores.

After reviewing our detailed road maps with the project team, FSG began our interdepartmental approvals and transition planning, followed by finite adjustments to the planned solutions, storage elevations, and individual workspace accommodations. We placed and quantified all medical equipment with relationship to the space and implemented standardization in both stocking & retrieval processes to help ensure that each department's planned solution mimics and compliments other support spaces. *This was/is done in part to ensure that PAR levels, FIFO, and labeling procedures are "like" and seamless so that hospital staff can quickly & easily identify the supplies and reduce hunting & gathering time instead of direct patient care.*

Our team will walk you through every step of identifying areas of concern & improvement, and then develop an ROI for each area with potential future impact so you can plan accordingly for future growth, emerging technologies, and departmental relocations.

<b>Storage Location</b>	<b>Existing Storage LFF and PAR Levels</b>	<b>Existing Equip</b>	<b>New Storage System</b>	<b>New Equipment</b>	<b>Efficiencies/ Emerging Tech</b>
-------------------------	--	-----------------------	---------------------------	----------------------	------------------------------------

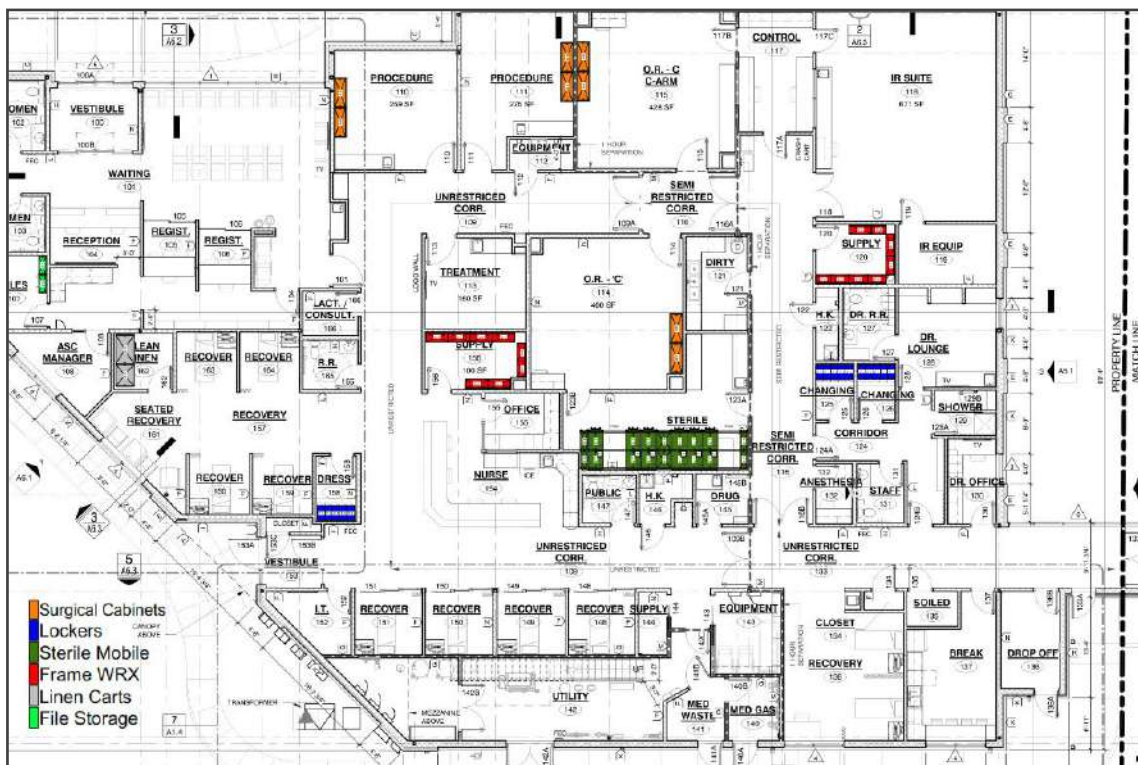

*FlowCARE's team compiled room-by-room storage data-sheets that outline type, size quantity, and set pricing for each space. Along with that, we will provide a detailed equipment list per room and supply detailed drawings of how the items shall co-exist.*

# ONE.STOP.SHOP

Since 1997, we've been supplying turnkey services for hospitals ranging from 25 to 500 beds. One of the key and deciding differentiator's for this Project Team to contract with FlowCARE Solutions Group, was our unique ability to bundle all products under one contract.

**Such bundling agreements offer a way for GPO customers to access even lower prices and standardize their purchases through a single supplier.**

## PRODUCT SOLUTIONS PROVIDED:

- Pull-Out Nurse Server in patient rooms
- Stainless Steel Pass-Through Surgical Cabinets
- Facility-wide, wire shelving for clean supply
- Linen Carts
- Soiled Hampers
- Bulk Transportation Carts
- Exchange Carts
- Rubbermaid Trash Cans
- Kanban bin systems
- Acrylic locking med boxes
- Pharmacy Casework & Unit Dose Shelving
- Stainless Steel Ante Room Casework
- Glass Door Cabinets in Sterile Corridor
- Lockers
- Gift Shop Displays & Casework
- Wall Mounted Catheter Racks
- Endoscopy Storage Cabinets
- Surgical Case Carts
- Crash Carts
- Anesthesia Carts



Department	Room Number	Product
Med Surg	4201-4224	Soiled Linen Cart w/bag Canvas Bags Acrylic Medication Lock Box "A" TYPE
	4232A	Wire Cart 36" x 18" x 69"(5-Tier)
	4249	Wire Cart 36" x 18" x 69"(5-Tier)
		Bulk Transport Cart 37 CFT W/Cover ( 48"w x 29"d x 55h") Exchange Cart MY2636-35

Department	Room Number	Product
LDRP	4260-4265	Soiled Linen Cart w/bag Acrylic Medication Lock Box "B" TYPE

# MANAGE/DELIVER/INSTALL

FlowCARE Solutions will deliver all products (deemed necessary) to our offsite warehouse, pre-assemble all solutions, deliver them on scheduled dock-time, and install all products into their respective spaces.

The end result = astonishing time & cost savings with seamless installation and integration that allows your to transition to your new space without missing a heartbeat.





**FlowCARE<sup>®</sup> products & services  
offered through Moduflex, LLC.**

**Moduflex LLC.**

5845 S. 118th Circle

Omaha, NE. 68137

[www.flowcaresolutions.com](http://www.flowcaresolutions.com)

## **SUBJECT MATTER EXPERTS**

- Medical Equipment
- Storage Systems
- Inventory Control and RFID
- Patient Rooms, Lockers, and Millwork

MODULAR PHARMACY & LAB CASEWORK // SURGICAL-SUPPLY STORAGE // SPD CARTS & TABLES // MEDICAL  
CARTS // CATHETER CARTS // ENDOSCOPY STORAGE // PASS-THROUGH SCOPE CABINETS // PASS-THROUGH NURSESERVERS  
//STAINLESS STEEL CABINETS // CLEAN-ROOM PASS-THROUGHS // SOLID-SURFACE CASEWORK //  
KANBAN BASKETS SOLUTIONS // LOUVERED BIN SYSTEMS & STEEL PEGBOARD // LAMINATE LOCKERS // PHENOLIC  
LOCKERS // WIRE-SHELVING // WIRE-CARTS // AND MUCH MORE